

Path: G:\Projects\OpenSpacePreserve\CoyoteRidge\CoyoteRidge_PublicAccess\PublicAccess_Draft\PublicAccess_Draft.aprx

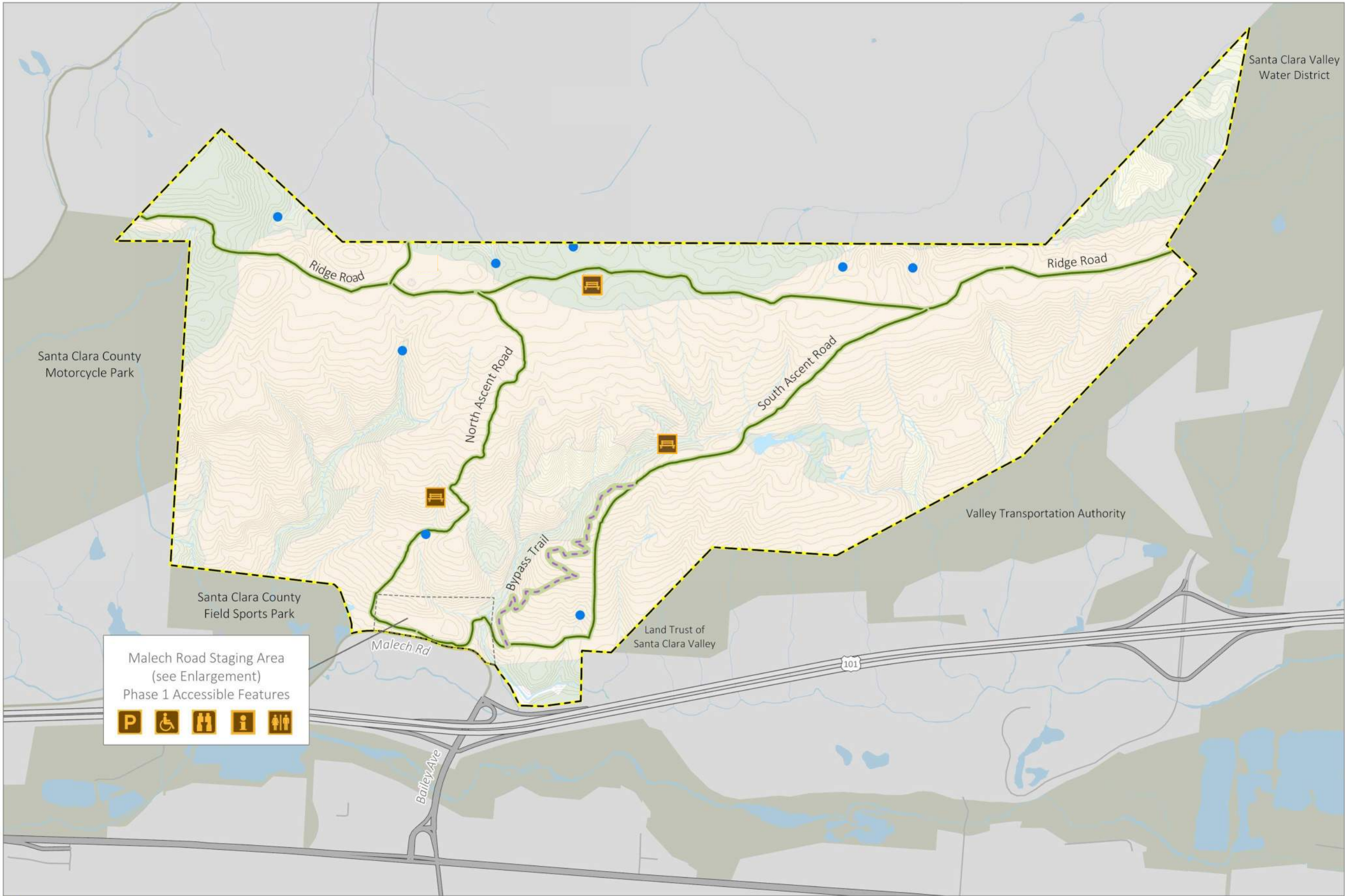

Proposed Public Access

- Parking Area (20 - 30 Vehicles)
- Accessible Restroom
- Interpretive Station, Signage
- Overlook
- Rest Area
- Existing Ranch Road, Public Trail
- New Trail

Natural Resources

- Ponds
- Water Features
- Serpentine Bunchgrass Grassland
- Non-dominant Land Cover

Other

- Malech Road Property Boundary
- Coyote Ridge OSP Boundary
- Other Protected Lands

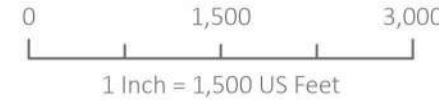

Malech Road Staging Area
(see Enlargement)
Phase 1 Accessible Features

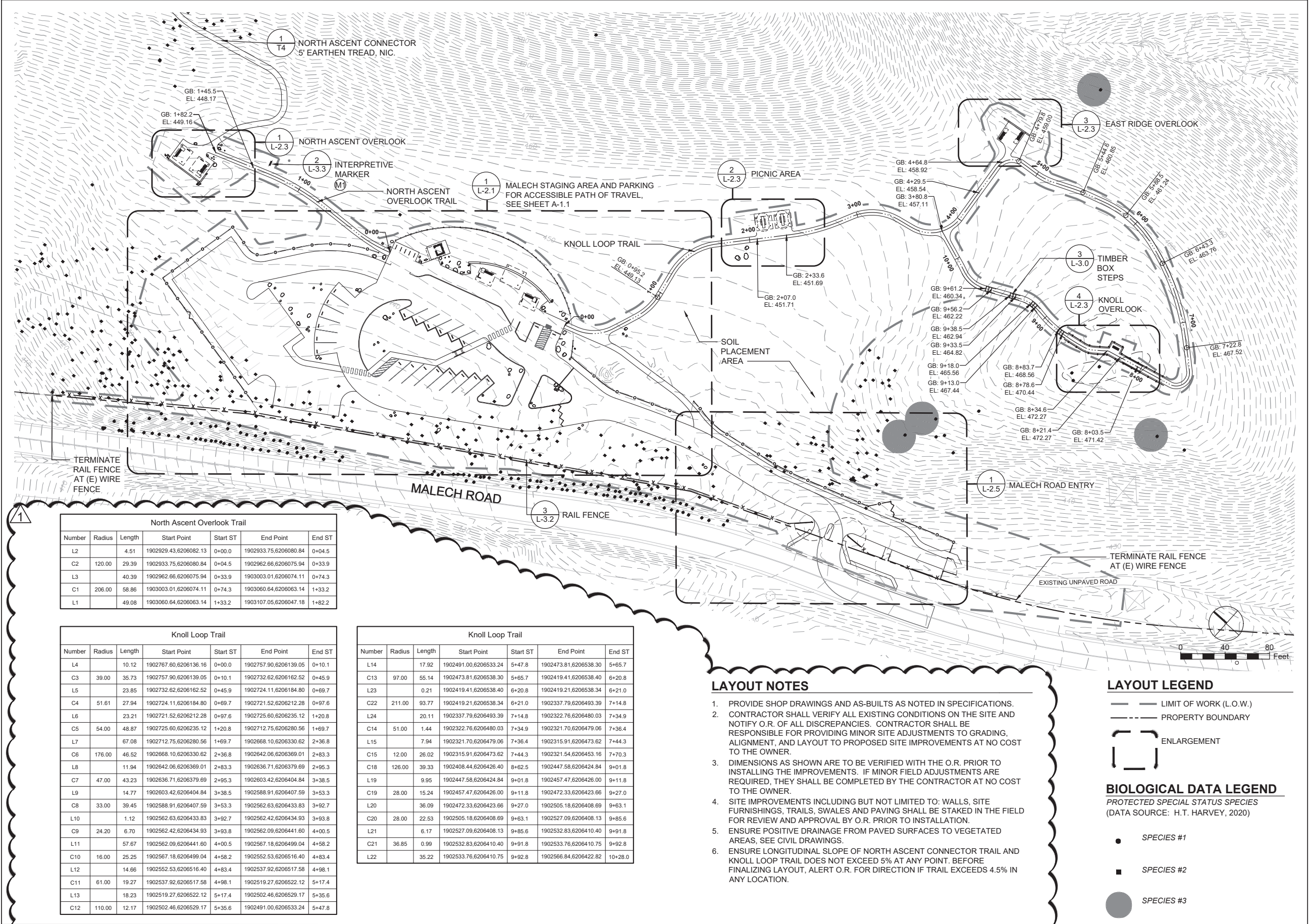

REVISIONS	
DATE	DESCRIPTION
01.18.22	REV1: COUNTY CMINT RESP

PROJECT TITLE
COYOTE RIDGE OPEN SPACE PRESERVE
PUBLIC ACCESS IMPROVEMENTS

SHEET TITLE
MALECH ROAD OVERVIEW

DESIGN PHASE
PERMITTING DOCUMENTS

Restoration Design Group, Inc.
2332 Fifth Street, Suite C
Berkeley, CA 94710
T 510.644.2798 F 510.644.2799
www.restorationdesigngroup.com

DESIGN BY ES, AS
DRAWN BY AS, KB, NS
CHECKED BY EQ
SCALE 1" = 40'-0"
DATE JAN 21, 2022
SHEET
L-2.0

C:\USERS\NAT\RESTORATION\DESIGN\GROUP\PROJECTS\17-COYOTE RIDGE\O&A\WORKING DRAWINGS\SHEET\STC\RDLS-MALECH.DWG PLOTTED ON: 1/21/2022